

AERODROME
CHART - ICAO

37°27'45"N
126°26'21"E

ELEV 7 m

TWR 118.2(E) 118.8(W)
GND 121.75(E) 121.7(W)
APRON 121.65 122.175 123.675
121.8 123.325

SEOUL / Incheon Intl

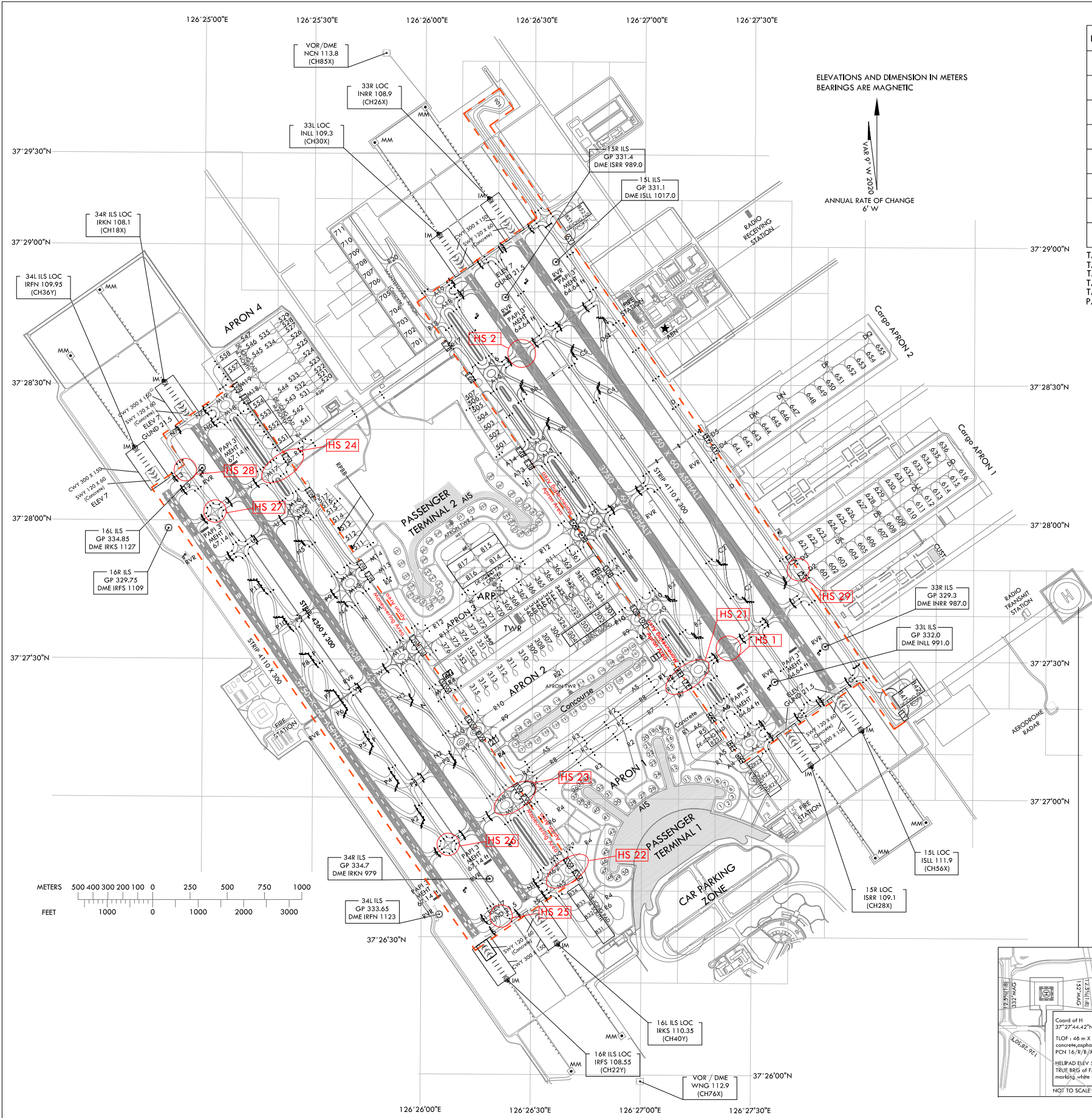

RWY	DIRECTION (MAGNETIC)	THR	BEARING STRENGTH
15R	153°	37°28'54"N 126°26'11"E	PCN 88/F/B/X/T Asphalt (SWY and 300 m RWY ends are 86/R/B/X/T Concrete)
33L	333°	37°27'15"N 126°27'39"E	PCN 88/F/B/X/T Asphalt (SWY and 300 m RWY ends are 86/R/B/X/T Concrete)
15L	153°	37°29'02"N 126°26'25"E	PCN 88/F/B/X/T Asphalt (SWY and 300 m RWY ends are 86/R/B/X/T Concrete)
33R	333°	37°27'23"N 126°27'53"E	PCN 88/F/B/X/T Asphalt (SWY and 300 m RWY ends are 86/R/B/X/T Concrete)
16L	153°	37°28'22"N 126°24'56"E	PCN 75/F/B/X/T Asphalt (SWY and 700 m RWY ends are 85/R/B/X/T Concrete)
34R	333°	37°26'36"N 126°26'30"E	PCN 75/F/B/X/T Asphalt (SWY and 700 m RWY ends are 85/R/B/X/T Concrete)
16R	153°	37°28'08"N 126°24'48"E	PCN 75/F/B/X/T Asphalt (SWY and 842 m RWY ends are 85/R/B/X/T Concrete)
34L	333°	37°26'28"N 126°26'16"E	PCN 75/F/B/X/T Asphalt (SWY and 842 m RWY ends are 85/R/B/X/T Concrete)

TAXIWAY A, D 30 m WIDE CONCRETE PCN 86/R/B/X/T
TAXIWAY B, C 30 m WIDE ASPHALT PCN 88/F/B/X/T
TAXIWAY M 30 m WIDE CONCRETE PCN 85/R/B/X/T
TAXIWAY N 30 m WIDE ASPHALT PCN 75/F/B/X/T
TAXIWAY P 30 m WIDE ASPHALT PCN 75/F/B/X/T
PAX Terminal and Concourse A VDGs equipped

HS 1	AIRCRAFT TAXIING ON TAXIWAY J FROM RUNWAY 15L AFTER LANDING USE CAUTION WHEN ATC UTILIZES RUNWAY 15R FOR TAKEOFFS. DO NOT CROSS THE HOLDING MARKING FOR RUNWAY 15R WITHOUT ATC AUTHORIZATION.
HS 2	AIRCRAFT TAXIING ON TAXIWAY K FROM RUNWAY 33R AFTER LANDING USE CAUTION WHEN ATC UTILIZES RUNWAY 33L FOR TAKEOFFS. DO NOT CROSS THE HOLDING MARKING FOR RUNWAY 33L WITHOUT ATC AUTHORIZATION.
HS 21 ~ 24, 29	USE CAUTION OF CONFUSION ON TAXIWAYS. DO NOT PROCEED TAXIING BEYOND TRANSFER OF CONTROL POINTS WITHOUT CLEARANCE FROM INCHEON APRON OR GROUND(TOWER).
HS 25 ~ 28	USE CAUTION OF CONFUSION ON TAXIWAYS.

LEGEND	
	VOR CHECK-POINT AND FREQUENCY
	Stop-bar light
	Runway Holding Position
	Taxi lane
	Gate
	Remote stand
	Open Channel
	ATC service boundary (Maneuvering Area)
	Transfer of Control Point (TCP)
	Hot Spot
	RPBB (Remote Passenger Boarding Bridge)

Note
Aircraft shall not taxi into maneuvering area without clearance from Incheon Tower or Ground.

Change : Information of taxilane, ACFT stands, TCP, stop-bar lights, intermediate holding position lights, and de-icing pad marking.

OFFICE OF CIVIL AVIATION

AIRAC AIP AMDT 11/22
Effective : 1600UTC 30 NOV 2022

MARKING AIDS RWY 15R/33L, 15L/33R, 16L/34R, 16R/34L AND EXIT TWY

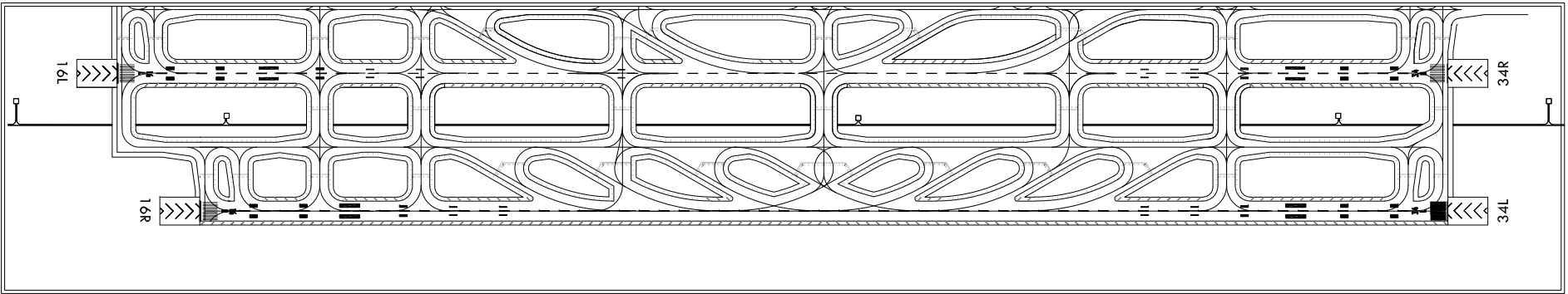
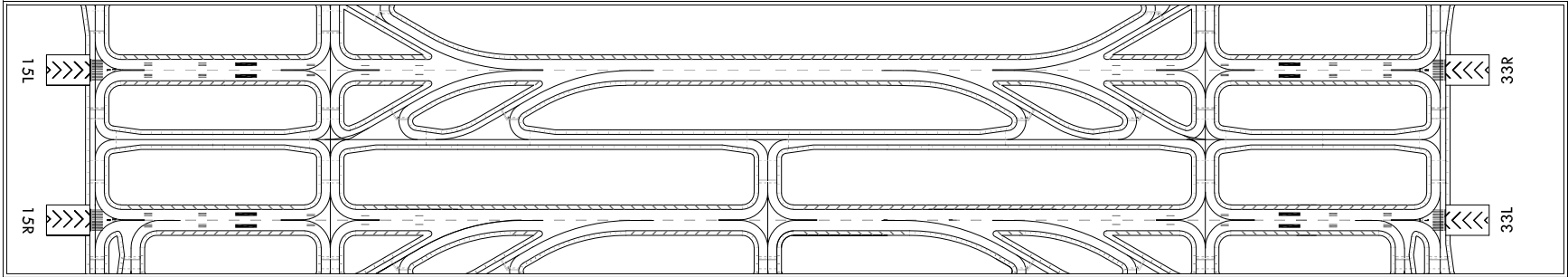

LIGHTING AIDS RWY 15R/33L, 15L/33R, 16L/34R, 16R/34L AND EXIT TWY

